

SUNPOWER

CryoTel® CT

11 W Cryocooler



Nominal Heat Load @ 77 K (23° C reject) 11 W

Nominal Input 160 W

Cooler Mass 3.1 kg

Temperature Stability ± 0.1 K

Power Supply DC 24V (12A)

Length 261 mm

Diameter 83 mm

Lowest Temperature < 40 K

Orientation any

AVC Compatible yes

Operating Frequency 60 Hz

MTTF $> 200,000$ hr



Base CT Cryocooler Dimensions

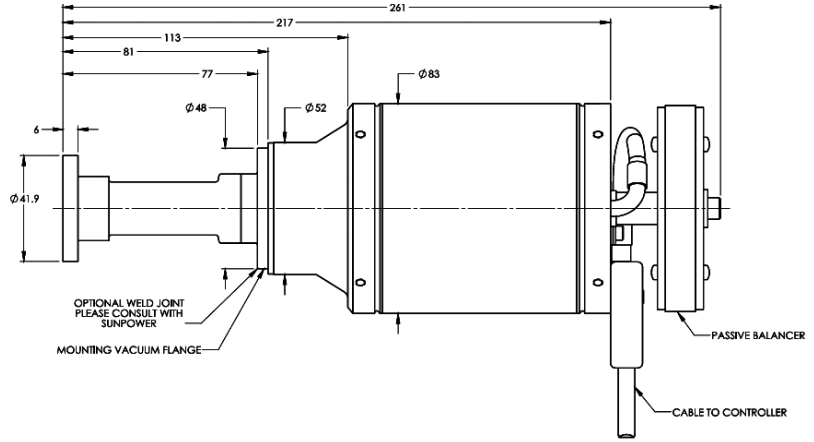
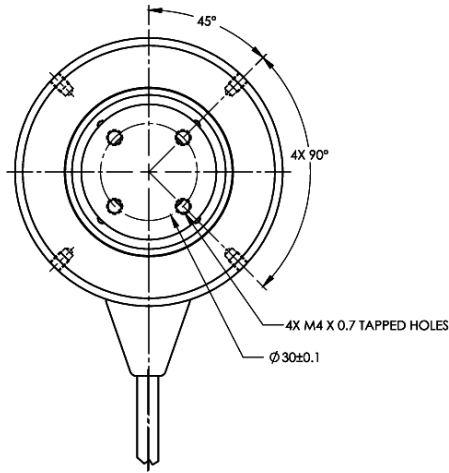

Nominal Performance to 300 K

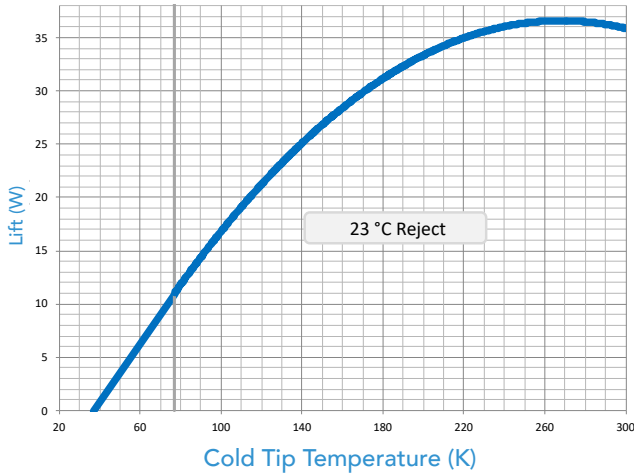

Nominal Performance at Different Reject Temperatures

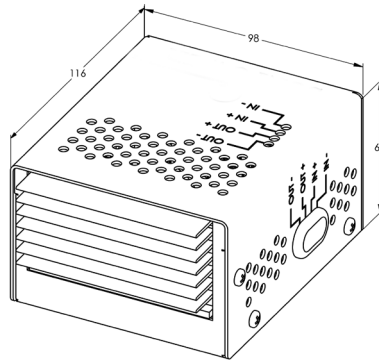
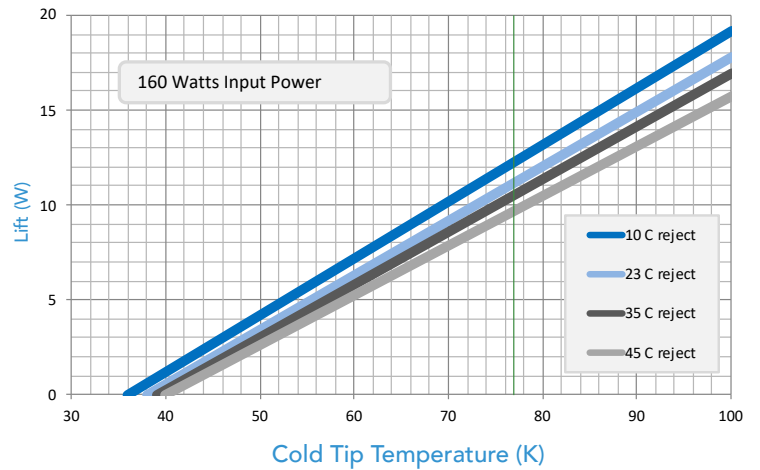

Data is subject to change.

Performance. Efficiency. Reliability.

The CryoTel® CT cryocooler was commercialized in 2001 after 10 years of cryocooler development for Sunpower. The CT has been used successfully in applications such as High Temperature Superconductivity (HTS) filters, high altitude balloons, refrigeration, germanium detectors, IR detectors, radio telescopes, laser diode cooling, research and others. The CryoTel CT represents the smallest 11 W @77 K cooler available with a Mean Time to Failure of >200,000 hours.



The most efficient cryocoolers on the market.

Please email sales@sunpowerinc.com for sales information.
2005 E. State Street, Suite 104, Athens, Ohio 45701 USA
www.sunpowerinc.com